

單層-A : Single Layer-A

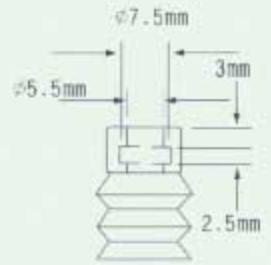

型號 Model	A4	A5	A7	A10	A15	A20	A30	A7-2	A10-2	A15-2	A20-2	A25-2	A30-2	A7-3	A10-3	A17-3
直徑 Diameter	4 m/m	5 m/m	7 m/m	10 m/m	15 m/m	20 m/m	30 m/m	7 m/m	10 m/m	15 m/m	20 m/m	25 m/m	30 m/m	7 m/m	10 m/m	17 m/m

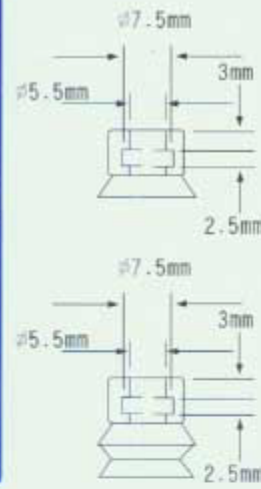

單層-B : Single Layer-B

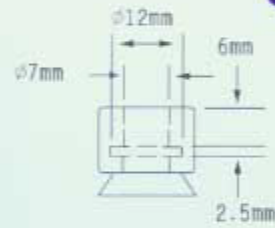

型號 Model	B10	B15	B20	B30	B40	B50
直徑 Diameter	10 m/m	15 m/m	20 m/m	30 m/m	40 m/m	50 m/m



雙層 : Double Layer

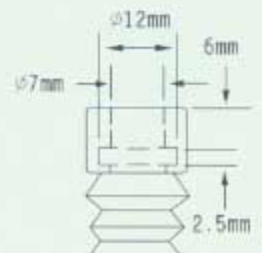
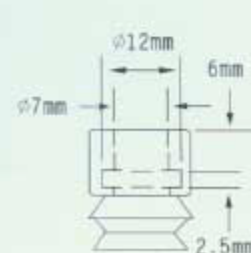

型號 Model	C10-2	C15-2	C20-2	C25-2	C30-2	C40-2	C20-3	C30-3	C40-3
直徑 Diameter	10 m/m	15 m/m	20 m/m	25 m/m	30 m/m	40 m/m	20 m/m	30 m/m	40 m/m

橡膠吸盤 (Rubber sucker)



橡膠吸盤 (適用於二次加工如噴漆、電鍍...等, 減少吸痕之用)

The rubber sucker is suitable for two processings like painting, the galvanization... And so on, reduces attract the mark to use!



橡膠吸盤系列 (Rubber Sucker Series)

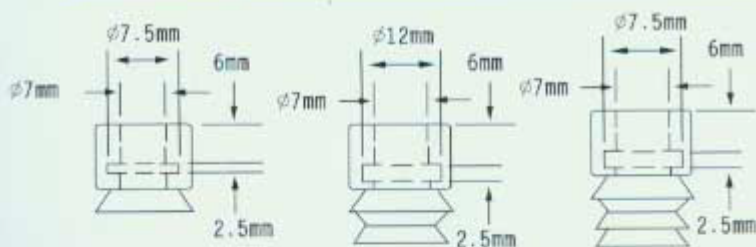

型號 Model	K4	K10-2	K15-2	K20-2	K30-2	K40-2	K6-3	K10-3
直徑 Diameter	4m/m	10 m/m	15 m/m	20 m/m	30 m/m	40 m/m	6 m/m	10 m/m



日本東芝原料 (耐溫300°C)

Japanese Toshiba Raw Material (Heat Resistance 300°C)

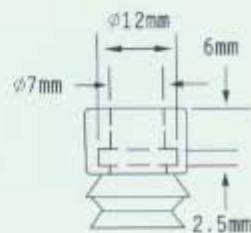
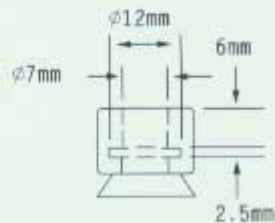

型號 Model	J8	J10	J15	J20	J30	J5-2	J7-2	J10-2	J15-2	J20-2	J25-2	J30-2
直徑 Diameter	8 m/m	10 m/m	15 m/m	20 m/m	30 m/m	5 m/m	7 m/m	10 m/m	15 m/m	20 m/m	25 m/m	30 m/m